

LEGISLATIVE RECEPTION EVENT DETAILS

New for 2024! OFDA is offering a guided tour of the Ohio Statehouse prior to the scheduled legislative briefing. Attend both events and receive 1 FULL hour of continuing education in Laws & Rules (*pending CE approval*).

3:00 PM: OFDA Ohio Statehouse Guided Tour (1/2 Hour CE)

- RSVP Required
- Arrive 15 minutes early in the **MAP ROOM** (Ground Floor)
- Tour begins promptly at 3:00 PM

4:15 PM: OFDA 2024 Legislative Brief (1/2 Hour CE)

- RSVP Required
- Located in the **THOMAS WORTHINGTON CENTER/ROOM** (Ground Floor)
- Briefing begins promptly at 4:15 PM

5:00 PM: OFDA Legislative Reception

- Located in the **STATEHOUSE ROTUNDA** (First Floor)

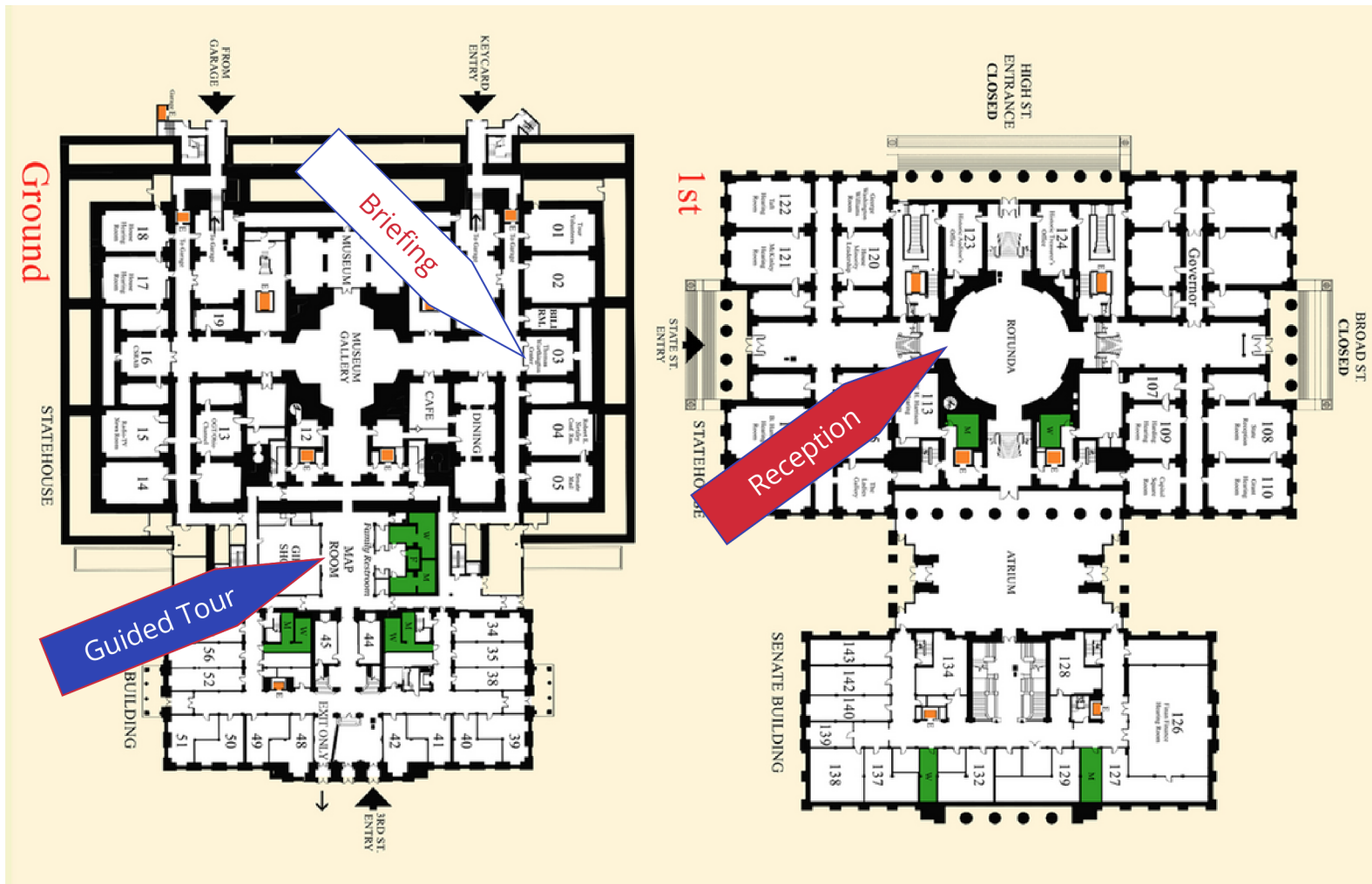



Directions to the Ohio Statehouse

Where is the Statehouse?

The Ohio Statehouse is located in downtown Columbus on the corner of High and Broad Streets.

Parking at the Statehouse

The Statehouse offers underground parking with direct sheltered access to the Ohio Statehouse. You can enter the parking garage from Broad, State or Third Streets.

Simply pull a ticket and park in any non-reserved spot. It is suggested that you park on the green parking level, but there is additional parking spots on the yellow and blue levels.

From the Parking Garage to the Ohio Statehouse

Once you have parked your car please head to the green level of the parking garage. You'll enter the Statehouse through a set of sliding glass doors near aisle 8, in the middle of the green level, where you will see a sign above the door that reads "Ohio Statehouse."

Note: there are more than one set of sliding glass doors on both sides of the parking garage. Please find the sliding glass doors that say "Ohio Statehouse" above.

Once you enter the sliding glass doors, go to the top of the stairs, where you will be greeted by an Ohio Highway Patrol Officer (you will go through security at this time). Once through security, please follow the directional signage posted behind the Ohio Highway Patrol Officer.

From the 3rd Street Entrance to the Ohio Statehouse

Once you have entered through the 3rd Street doors, there will be two sets of white marble staircases in front of you, please follow directional signage either on or in-between the white marble staircases.

You may also ask any Ohio State Highway Patrol Trooper for directions.